

DT LITE

Industrial Capabilities

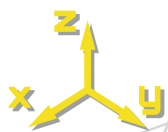

Large printing volume



Affordable Technology



4 printing modes



Professional tool



DT LITE

Reliability

Large print volume with many technical materials.

DT LITE is a filament fusion 3D printer capable of working with the majority of thermoplastic materials offering an ideal versatility for your company.

Print volume **600 x 450 x 450 mm**
Printer size 1140 x 740 x 1725 mm

Precision Z axis: 1,6 micrones
Precision XY axis: 16 micrones

Max. extruder temperature **300°C**
Max. environment temperature **50°C**
Max. bed temperature **120 °C**

Nozzle diameter 0,6 mm
Other available diameters 0,2 / 0,4 / 0,8 / 1 / 1,2 mm
Titanium thermal barrier
Double independent extruder
Heated filament feeder
4 printing modes : SINGLE, DUAL, TWIN, REFLEX

220 - 240 V, 50-60 Hz
Maximum consumption 3 kW/h
7" LCD touch screen
Remote monitoring
Conectivity: Wifi, ethernet, hotSpot, USB
UPS Housing
MMS System - Modular maintenance system

Dual extruder

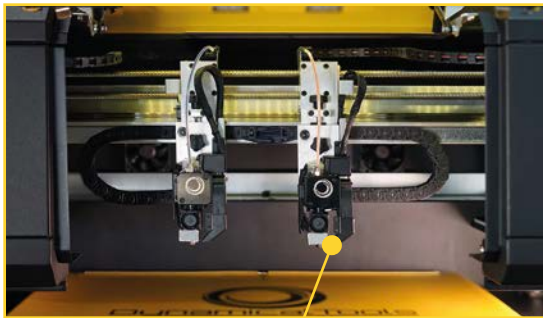

7" LCD Touchscreen



Titanium thermal barrier

Extruder temperature up to 300°C

Heated chamber up to 50°C

Heated bed up to 120°C

Heated Feeders



Large build volume
600 x 450 x 450 mm

Tool Tray

UPS housing

With the DT LITE industrial 3D printer you can print:

We have all those materials characterized and ready to print with Simplify3D custom profiles



- PLA PRO DT
- ABS PRO DT
- ASA PRO DT
- PETG PRO DT
- HIPS PRO DT
- FLEX SOFT DT
- TPU DT
- CARBON-PRO DT
- PLA 3D850 SM
- PLA 3D870 SM
- FLEX SM
- GLACE SM
- PLA HT 3dkTOP

4 Printing modes

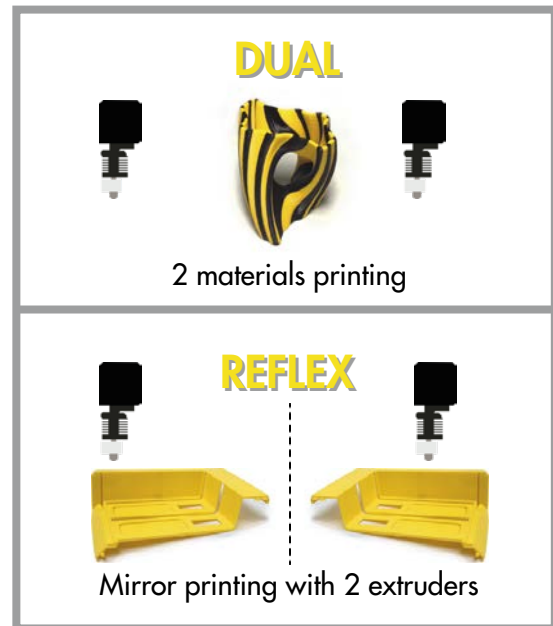
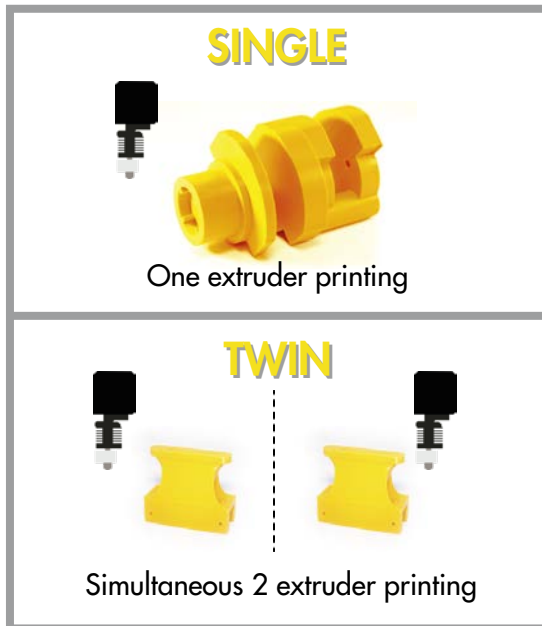

Application / Sectors



Education / Arts



Consumer Products

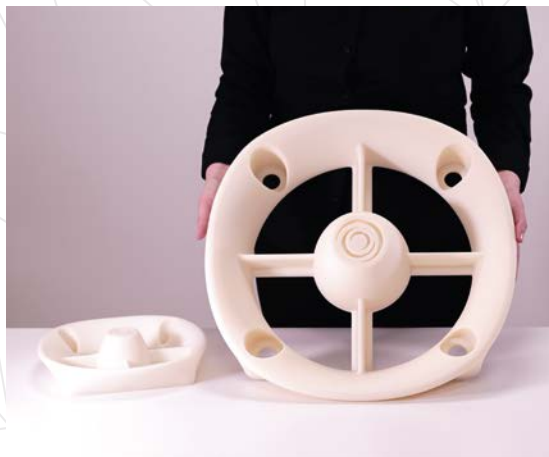

Prototyping

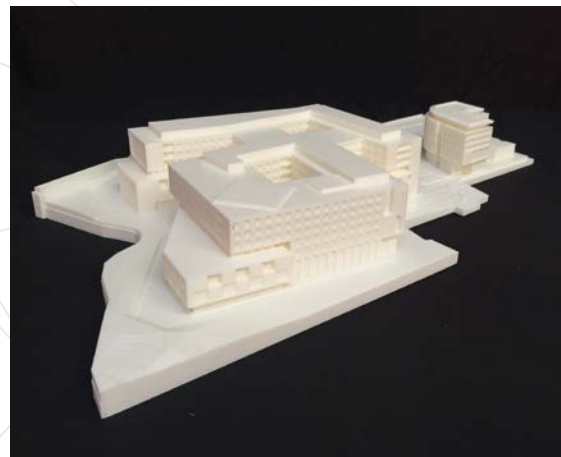

Architecture